

**Electrical Characteristics:**

Current rating: 0.4A AC/DC  
 Voltage rating: 50V AC/DC  
 Temperature range: -25°C~+85°C  
 Withstand Voltage: 500V AC/Minute  
 Contact Resistance: ≤ 20mΩ  
 Insulation resistance: ≥ 500MΩ  
 Relative Humidity: 93%+40°C

**Material Description:**

Terminal: Phosphor Bronze Tin-plated  
 Fitting Nail: Brass Tin-plated  
 Housing: Thermoplastic(UL94V-0)  
 Slider: Thermoplastic(UL94V-0)

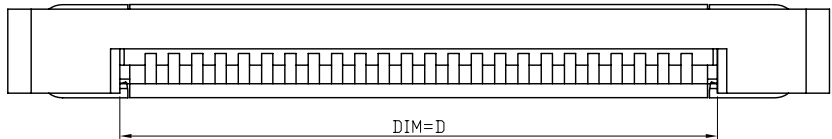
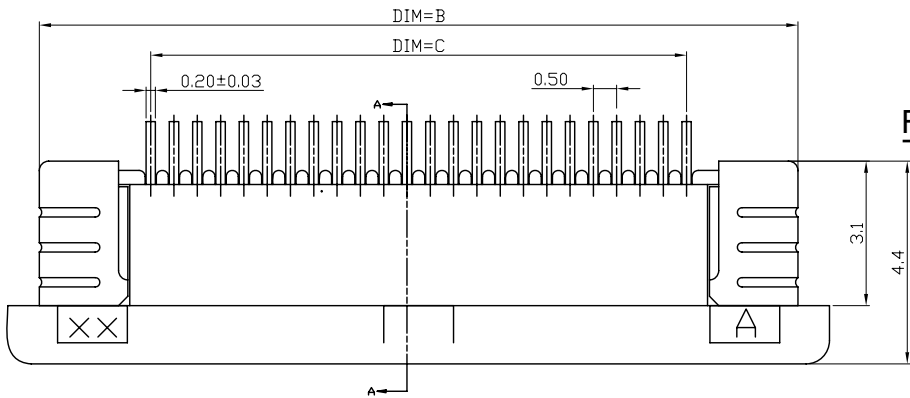
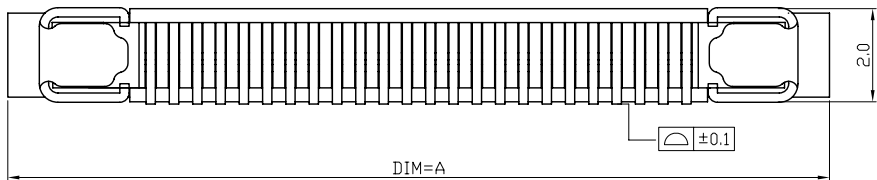
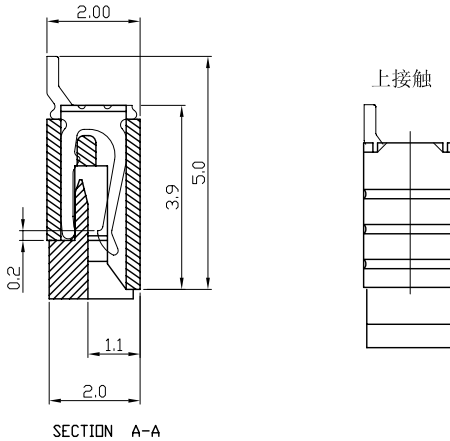

**FPC 05 20 02-xx U T**

- T: Tin OVER Nickel
- U: Upper Contact SMT Type
- PIN: 04-60
- 02: Drawer FFC T=0.3mm
- 2.0mm High
- 0.5mm Pitch
- FPC Connector

PIN数	DIM=A	DIM=B	DIM=C	DIM=D
34P	22.60	21.50	16.50	17.65
33P	22.10	21.00	16.00	17.15
32P	21.60	20.50	15.50	16.65
31P	21.10	20.00	15.00	16.15
30P	20.60	19.50	14.50	15.65
29P	20.10	19.00	14.00	15.15
28P	19.60	18.50	13.50	14.65
27P	19.10	18.00	13.00	14.15
26P	18.60	17.50	12.50	13.65
25P	18.10	17.00	12.00	13.15
24P	17.60	16.50	11.50	12.65
23P	17.10	16.00	11.00	12.15
22P	16.60	15.50	10.50	11.65
21P	16.10	15.00	10.00	11.15
20P	15.60	14.50	9.50	10.65
19P	15.10	14.00	9.00	10.15
18P	14.60	13.50	8.50	9.65
17P	14.10	13.00	8.00	9.15
16P	13.60	12.50	7.50	8.65
15P	13.10	12.00	7.00	8.15
14P	12.60	11.50	6.50	7.65
13P	12.10	11.00	6.00	7.15
12P	11.60	10.50	5.50	6.65
11P	11.10	10.00	5.00	6.15
10P	10.60	9.50	4.50	5.65
9P	10.10	9.00	4.00	5.15
8P	9.60	8.50	3.50	4.65
7P	9.10	8.00	3.00	4.15
6P	8.60	7.50	2.50	3.65

**0.5mm Pitch 2.0mm High Drawer touch up**

**深圳市联泽瑞科技有限公司**  
 SHENZHEN LIANZERUI TECHNOLOGY CO.,LTD.

				UNLESS OTHERWISE SPECIFIED		APPROVED		DATE		PART NO		
				TOLERANCES ARE		CHECKED		DATE		DRAWING NO		
				X.X ±0.15		DRAWN		DATE		COMPUTER NO		
				X.XX ±0.10		NUMBER		SCALE		SIZE		
				X.XXX				1:1		A4		
				ANG. ±0°30'				NAME		REV		
				UNIT				FPC0.5接拔式上接成品图		A		
				MM								
SER	AREA	REVISIONS	CHK	DATE								

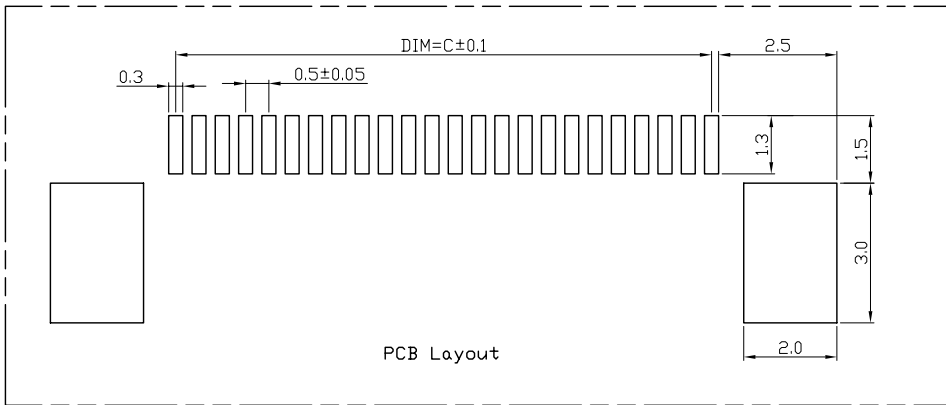

Electrical Characteristics:  
 Current rating: 0.4A AC/DC  
 Voltage rating: 50V AC/DC  
 Temperature range: -25°C~+85°C  
 Withstand Voltage: 500V AC/Minute  
 Contact Resistance:  $\leq 20m\Omega$   
 Insulation resistance:  $\geq 500M\Omega$   
 Relative Humidity: 93%+40°C

Material Description:  
 Terminal: Phosphor Bronze Tin-plated  
 Fitting Nail: Brass Tin-plated  
 Housing: Thermoplastic(UL94V-0)  
 Slider: Thermoplastic(UL94V-0)

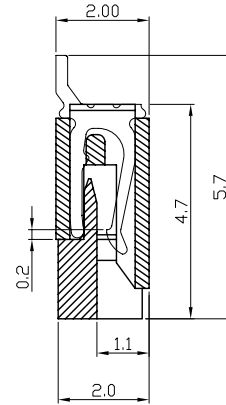

上接触

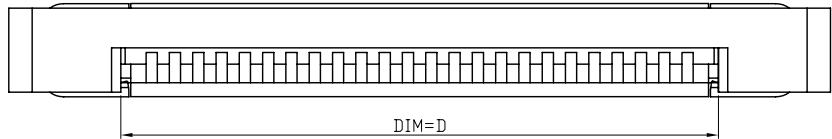
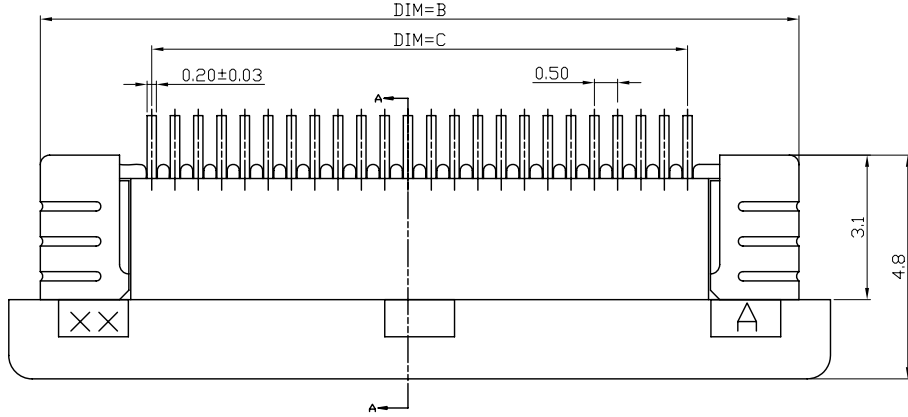
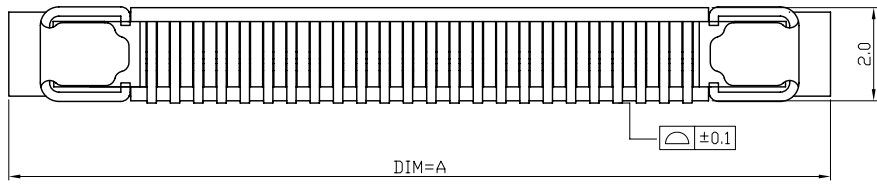
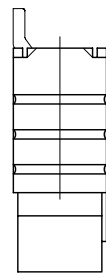

PIN数	DIM=A	DIM=B	DIM=C	DIM=D
60P	35.60	34.50	29.50	30.65
59P	35.10	34.00	29.00	30.15
58P	34.60	33.50	28.50	29.65
57P	34.10	33.00	28.00	29.15
56P	33.60	32.50	27.50	28.65
55P	33.10	32.00	27.00	28.15
54P	32.60	31.50	26.50	27.65
53P	32.10	31.00	26.00	27.15
52P	31.60	30.50	25.50	26.65
51P	31.10	30.00	25.00	26.15
50P	30.60	29.50	24.50	25.65
49P	30.10	29.00	24.00	25.15
48P	29.60	28.50	23.50	24.65
47P	29.10	28.00	23.00	24.15
46P	28.60	27.50	22.50	23.65
45P	28.10	27.00	22.00	23.15
44P	27.60	26.50	21.50	22.65
43P	27.10	26.00	21.00	22.15
42P	26.60	25.50	20.50	21.65
41P	26.10	25.00	20.00	21.15
40P	25.60	24.50	19.50	20.65
39P	25.10	24.00	19.00	20.15
38P	24.60	23.50	18.50	19.65
37P	24.10	23.00	18.00	19.15
36P	23.60	22.50	17.50	18.65
35P	23.10	22.00	17.00	18.15

0.5mm Pitch 2.0mm High Drawer touch up

深圳市联泽瑞科技有限公司  
 SHENZHEN LIANZERUI TECHNOLOGY CO.,LTD.

				UNLESS OTHERWISE SPECIFIED TOLERANCES ARE		APPROVED		DATE		PART NO	
				X.X ±0.15		CHECKED		DATE		PFC052002-XXUT	
				X.XX ±0.10		DRAWN		DATE		DRAWING NO	
				X.XXX		DRAWN		DATE		COMPUTER NO	
				ANG. ±0°30'		DRAWN		DATE		COMPUTER NO	
				UNIT		NUMBER		SCALE		SIZE	
				MM		1:1		A4		NAME	
				SER		AREA		REVISIONS		CHK	
				DATE		DATE		DATE		NAME	
				DATE		DATE		DATE		FPC0.5接拔式上接成品图	
				DATE		DATE		DATE		REV	
				DATE		DATE		DATE		A	